

Scale 160<sup>fs</sup> to the Inch

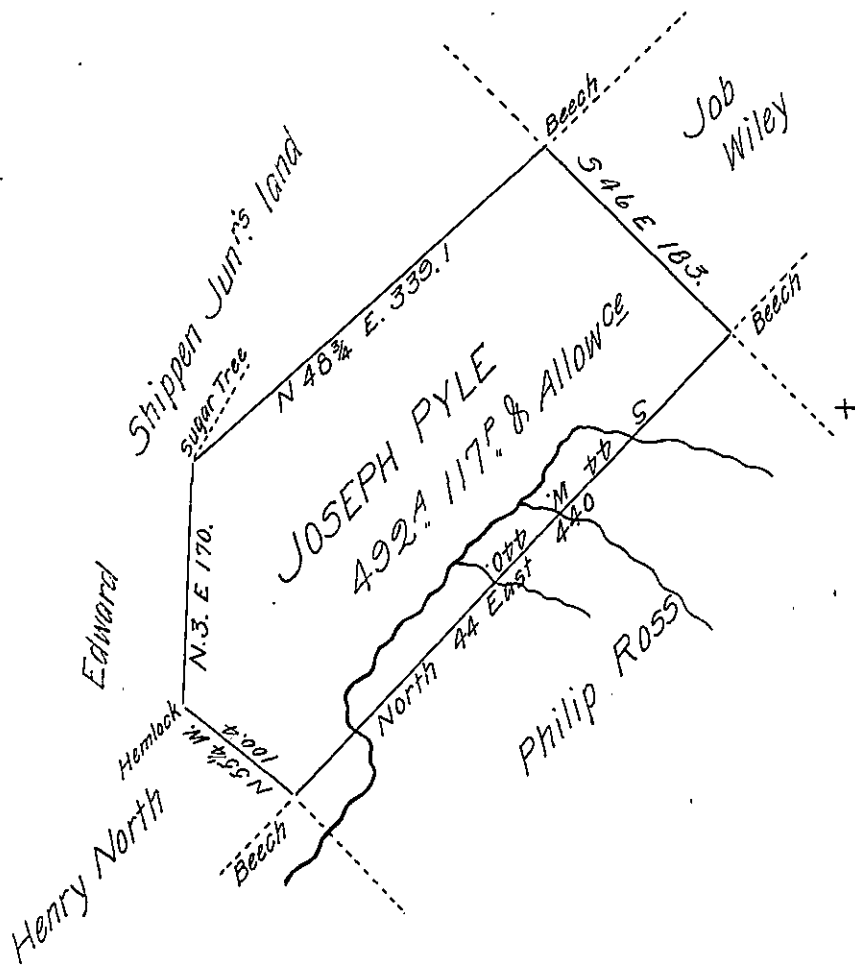

Draught of a Tract of Land called Pylesbury situate on Tunkhannock Creek in the County of Luzerne adjoining Land of Edward Shippen Junior containing four hundred and Ninety two Acres and One hundred and Seventeen Perches and the usual Allowance of Six per Centum for Roads surveyed for Joseph Pyle the fourth Day of May One thousand Seven hundred and Eighty Nine by William Gray Esquire late Deputy Surveyor in Pursuance of a Warrant dated the fifteenth Day of October 1788. and certified by me this 23<sup>d</sup> Day of ~~December~~ October 1802.

Tho. Sambourne

To Samuel Cochran Esq<sup>r</sup> }  
Surveyor General

DY. Surv<sup>r</sup>

N.B. This Quantity is greater than the usual Allowance but if not admitted there will be of Necessity a small Vacancy which will be of no Advantage to the State to retain.

T.S.

IN TESTIMONY that the above is a copy of the original remaining on file in the Department of Internal Affairs of Pennsylvania, made conformably to an Act of Assembly approved the 16th day of February, 1833, I have hereunto set my Hand and caused the Seal of said Department to be affixed at Harrisburg, this tenth day of May 1906.

*Grace D. Brown*  
Secretary of Internal Affairs.